

Mi·Light[®]

Model No.: LD1051371 Smart Panel Remote Controller

Product Features

B0 Smart Panel Remote Controller is designed by a delicate and fashionable tempered glass panel; And we adopt a high precision Capacitive touch screen IC. Touch Screen is very stable; 2.4GHz high RF wireless control with long distance controlling, low power consumption and high speed transmitting rate. Can control specified LD1051372 - LD1051373 -LD1051374 controller.

Panel Remote Controller Name	Compatible products
Smart Panel Remote Controller	LD1051372 RGB LED Strip Control System LD1051373 RGBW LED Strip Control System LD1051374 RGB+CCT LED Strip Control System

Technical Parameters

Working Temperature: -20-60°C
Input Voltage: 3V(2*AAA Battery)
Radio Frequency: 2400-2483.5MHz
Modulation Method: GFSK

Transmitting Power: 6dBm
Control Distance: 30m
Standby Power: 20uA
Size: L86mm*W86mm

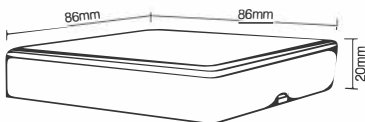

Products Key Diagram

Remark: When touching the button, LED indicating lamp will flash once with different sound(Touch slider with no sound).

OFF: Long press OFF button for 10 seconds to close the sound.

ON: Long press ON button for 10 seconds to open the sound.

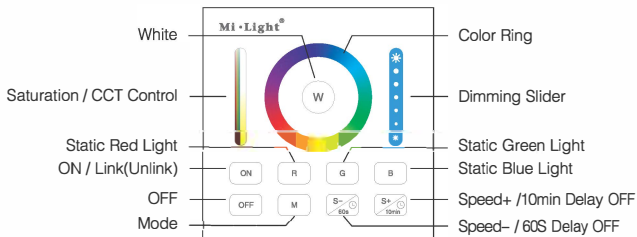

- Touch the color ring to change colors.
- Under white light mode, adjust color temperature;
Under color light mode, change color saturation.
- Slide the brightness slider to adjust the brightness.
- Press the button to get white light.
- Touch ON button, turn on the linked device.
- Touch OFF button, turn off the linked device.

- R Static Red Light.
- G Static Green Light.
- B Static Blue Light.
- M Dynamic mode switching button.
- S+ Accelerate the speed under present dynamic mode.
Under static mode, Long press for 2 seconds, the light shine once, the light will be off after 10 minutes.
- S- Slow the speed under present dynamic mode.
Under static mode, Long press for 2 seconds, the light shine once, the light will be off after 60 seconds.

Linking&Unlinking

Remark: The light can be working after linking with the remote controller.

Linking Instructions

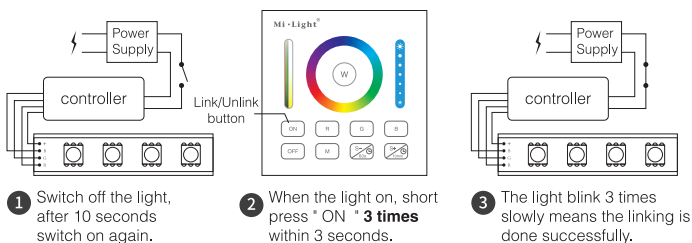

! If the light not blink slowly, the linking failed, PIs switch off the light again, and follow the above steps again.

Unlinking Instructions

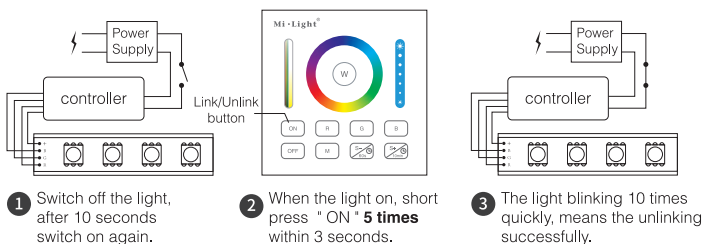

! If the light not blink quickly, the unlink failed, pls switch off the light again, and follow the above steps to unlink again.

Installation / Dismantlement

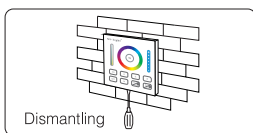
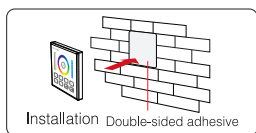

Attention

1. When installation, pls handle with care to avoid the broken of the glass panel.



Made in China