

WIFI Curtain Switch

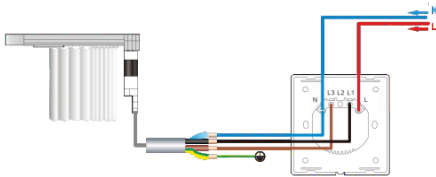

User Guide

1.Wiring Diagram



2.Specification

- *Working Voltage:AC110-240V(50/60Hz)
- *Normal Load Power:≤600W
- *Maximum peak current:10A
- *Maximum peak power:2400W
- *Standby consumption:0.1mA
- *Wireless Protocol:WIFI 2.44GHz
- *Wireless Range:30 Meters(Indoor)
- *Switch Standard:EU/UK
- *Material:ABS flame retardant

3.Download and Install App

Use your phone to scan the QR code below or search" Smart Life"from Apple store or Google play to download the APP.



Input account name and password to log in. If you don't have an account, please register an account first. System will identify your country automatically. You can use your mobile phone number or Email address as your account name.

Tap on "Next" to get a verification code via SMS on your mobile phone. Enter a desired password. Tap on "Confirm" to finish your registration.

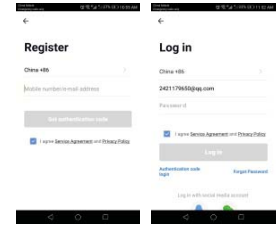

4.Add New Device

- 1 Connect your phone to local wifi first
- 2 Press and hold the "Up" key for 20 seconds until the indicator light flashes quickly
- 3 On the Smart Life APP, tap on "+" in homepage Select "Wall Switch"
- 4 Input wifi password and confirm
- 5 Wait for successful configuration

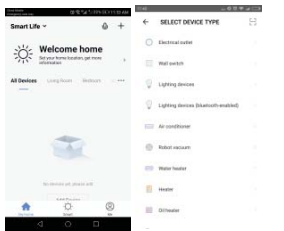

5.Control on App

After successful configuration, you can control the WiFi curtain switch on the App. You can open/close the curtain.

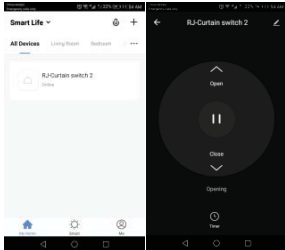

6.Set Timer

You can set a schedule to open/close your curtain.

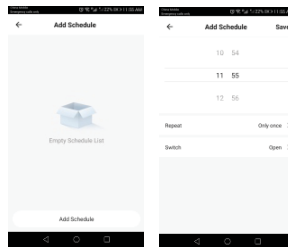

7.Share Device

- 1 Select "Device Sharing" in Profile
- 2 Tap on "Add"
- 3 Input the cell phone number/email you want to share with
- 4 Device will automatically be listed in your shared account

8.Manually reset the curtain switch

Repeat step 5 to reset the device

9.How to control device by Amazon Alexa

Open the "Amazon Alexa" APP. Go to "Home" and select "Skills". Input "Smart Life" in the search bar. Tap on "Enable" to add the skill. Enter your "Smart Life" APP account name and password. Then tap on "Link Now" to continue. After the link succeeds, close the window and go back to the Alexa APP.

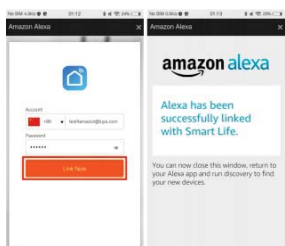
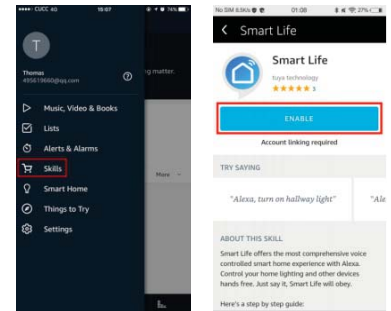

Tap on "Smart Home", select "Devices" and then tap on "Discover". Alexa will discover devices. After about 20 seconds, the devices will show in the list.

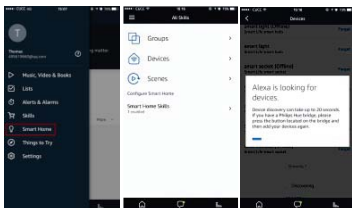

Now you can use your Alexa to voice control your Smart devices. "Alexa, turn on/off bedroom curtain."

10.How to control device by Google Home

Open the "Google Home" or "Google Assistant" APP. Go to "Home" and select "Home Control". Tap on "+" in the lower right corner to add skill. You can find "Smart Life" in "Add devices" list.

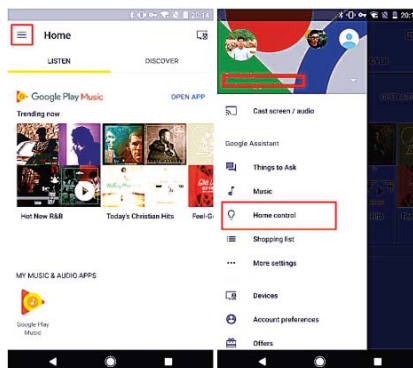

Select your country code. Enter your "Smart Life" APP account name and password. Then tap on "Link Now" to continue. After the link succeeds, you can assign rooms for your smart devices. Later you can find the smart devices in the Home Control list.

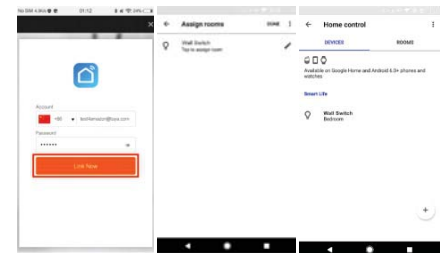

Now you can use your Google Home to voice control your Smart devices. "Ok, Google, turn on/off bedroom curtain."