

LED  
BULKHEAD LAMP  
FLOOD LIGHT

HIGH POWER



**FL Series**

**Include: 500W/400W/300W/200W/150W/120W/100W**



# THREE TECHNOLOGICAL INNOVATIONS

1. High power LED heatsink has perfectly replaced the traditional 400W-2000W Metal Halide lamp, this energy-saving cutting edge innovation fills the gap in the LED heatsink market.
2. FL Series' four patented technologies: HDT, zipped-fin, crimped fins, compressed pipe making the high power LED heatsink lighter, easy to instal, solid in structure, super heat dissipation.
3. Modular design, making power diverse, enriching product line.



## Applications

Factory, gymnasium, lighting decoration, square, golf course, vessel, airport, metro station, business area, flyover, outdoor advertising, landmark and so on.





# Four design highlights



## 216° adjustable angle

13 adjustment points on the bracket, the angle can be adjusted 216°, the whole lamp's irradiation angle changes freely.



heatpipe product

## Copper heatpipe

By riveting the heatpipe to the fins, the heatpipe can conduct heat rapidly from chips bottom to the fins, greatly lower down the temperature of light source, extending its life span.

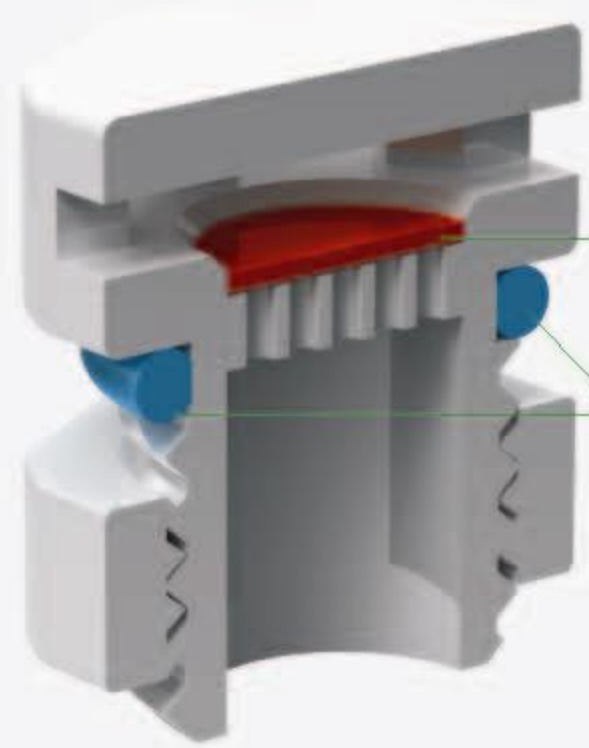

e-PTFE Breathable membrane  
Waterproof rubber ring

## Respirator design

Waterproof design, eliminating mist, avoiding condensation, improving quality, extending the life span.



## 92% reflective rate

Reflector's beam angle 60°/30°. Reflective rate could reach up to 92%.